

POWERVERTER Pro

PVPro-L SEAT MOUNTED READING LIGHT

PVPro-L - THE DISCREET SOLUTION FOR PERSONAL SEAT MOUNTED READING LIGHTS

Achieving the correct ambient lighting in buses and coaches while driving at night can be a challenge. Some passengers may wish to snooze, others might like to read a book or magazine, check and update mobile phones or other media devices.

This causes the dilemma. Lights on or off? At night, typically lights are dimmed and passengers can choose a private reading light, usually situated in the ceiling of the vehicle which then shines on the appropriate seat, illuminating their surroundings. However, to reach from the ceiling, such lights need to be quite bright. This can cause annoyance to nearby passengers, as well as a significant rear view distraction to the driver as lights flash on and off while the vehicle is in motion. The Alfatronix PVPro-L reading light offers the ideal solution. It can be installed in the back of the seat in front. The light ray can be directed to the left or right as well as forward or backwards for discreet, yet maximum comfort for both the user and their neighbours.



PowerVerter USB PVPro-D and PVPro-L

As it is situated behind the seat, there is no stream of light from the ceiling, so neither the driver nor other passengers are distracted. The PVPro-L reading light is designed to match with our already popular PVPro range of USB chargers. With passenger accessible charging and directable personal lighting, these two products offer a simple and inexpensive offering that significantly enhances customer experience.

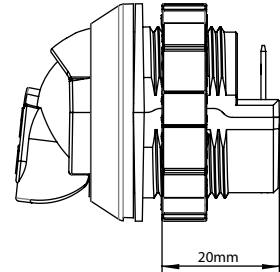

Slim design can be installed with as little as 20mm rear space.



Directable personal lighting, easy to switch on and off.



Part Number	Description	Dimensions (mm)	Weight
PVPro-L	12/24 seat mounted reading light	Ø37 x 45; Hole Ø30	19g

For 12/24 Vdc USB Chargers, please see our PowerVerter Pro Range.

TECHNICAL DATA

Input voltage range	9-32Vdc
Output light	500 lux @ 0.25m, 225 lux @ 0.5m
Application	Directable reading light for installation in seat back
Transient voltage protection	Meets ISO7637-2 International standard for 12/24V vehicles
Off load current (quiescent current)	< 2mA @ 12V, 7mA @ 24V
Power conversion efficiency	Light on 98mA @ 12V, 48mA @ 24V
Operating temperature	-25°C to +55°C to meet this specification table
Storage temperature	-25°C to +100°C
Operating humidity	95% max., non-condensing
Casework	Polycarbonate body
Connections	Input: 6.3mm push-in flat blade connectors On/off switch incorporated
Output indicator	Blue LED output indication when reading light off
Mounting method	30mm diameter hole with or without bezel.
Safe area protection:	Over heat Limited by temperature sensing circuit
Overvoltage and Undervoltage	Limited by sensing circuit
Reverse Polarity	Limited by sensing circuit
Transients	Protected by filters and rugged component selection
Catastrophic protection	Internal fuse
Approvals	2014/30/EU The general EMC directive Regulation 10 The automotive directive 93/68/EEC The CE marking directive AES5, ECE R118.02 and UL 94: V-0
Designed to	EN50498, EN61373, EN45545-2 and ISO 7637-2 To fully meet railway approval to EN50155 & EN50121-3-2 the PVPro-L is to be used in conjunction with a PV6i-R or PV12i-R Please see PowerVerter PVPro Railway
Markings	CE and E (automotive) marked
IP Rating	IP30